

Creating Graded Evolve Assignments in Brightspace by D2L

Introduction: This guide will walk you through creating graded assignments in Brightspace by D2L.

NOTE: There are 4 types of products that have assignments that can be linked to Brightspace by D2L using these steps: **Clinical Skills, Elsevier Adaptive Learning,** and select versions of **Evolve Resources, and Online Courses.** In Evolve resources and online courses the only assignments that will pass directly to the gradebook will be inside of a folder marked as gradable resources.

External Tool Setup

1. Login to Brightspace by D2L and go to your desired course.
2. Click the **Content** tab in the upper-left-hand corner

Content Grades Class Progress Course Tools ▾ Help ▾

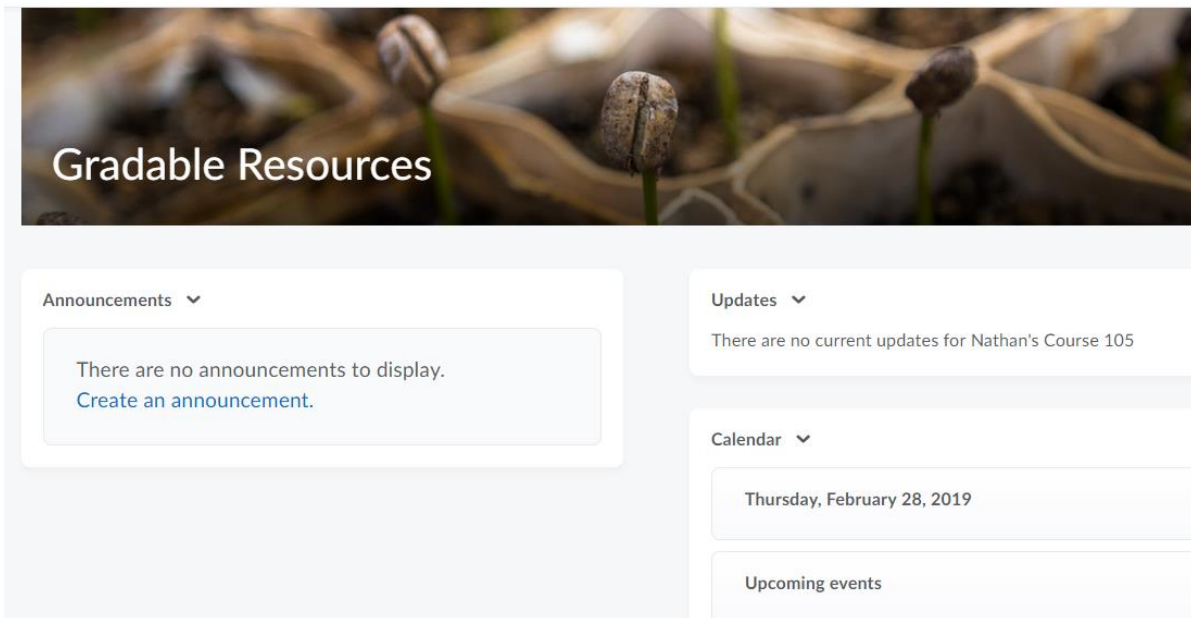

Gradable Resources

Announcements ▾

There are no announcements to display.
[Create an announcement.](#)

Updates ▾

There are no current updates for Nathan's Course 105

Calendar ▾

Thursday, February 28, 2019

Upcoming events

3. Open **Evolve Link** in a new tab.

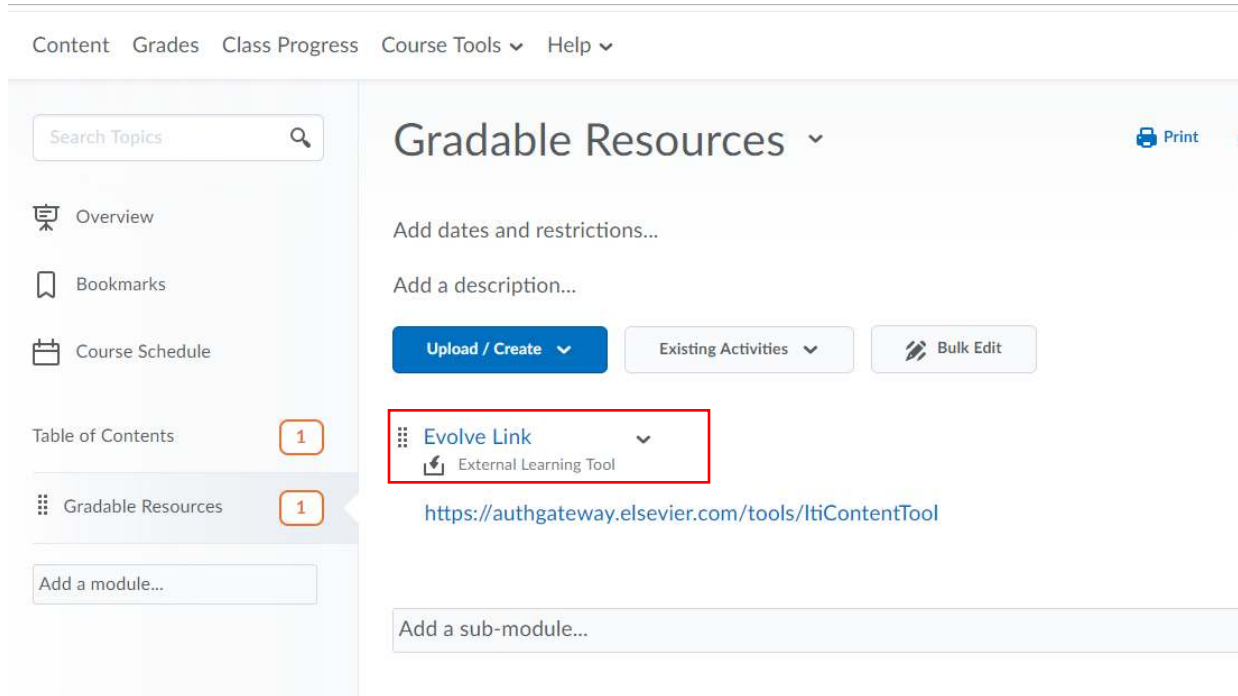

- **NOTE:** For Evolve Link setup assistance please view “Adding Evolve Content to Brightspace by D2L”

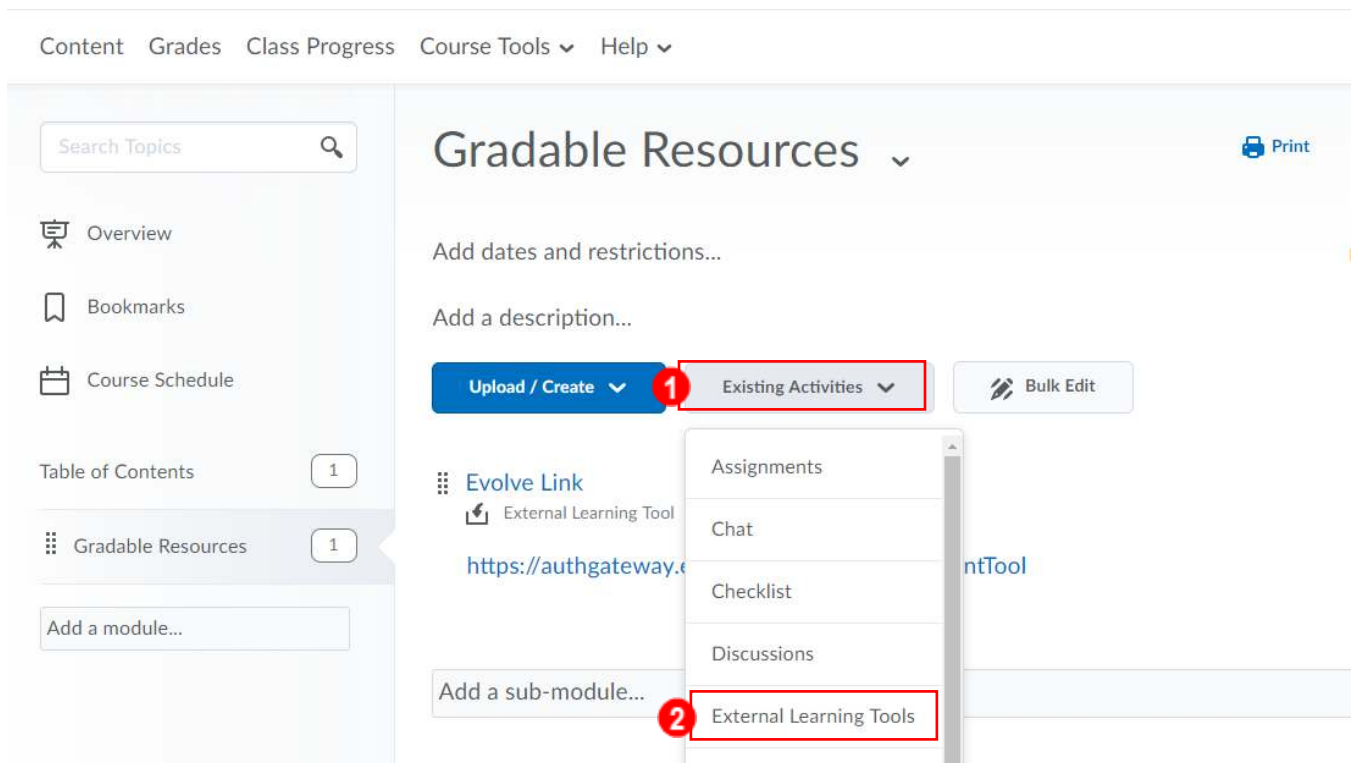

4. In the Brightspace by D2L tab click **Existing Activities** followed by **External Learning Tools**.

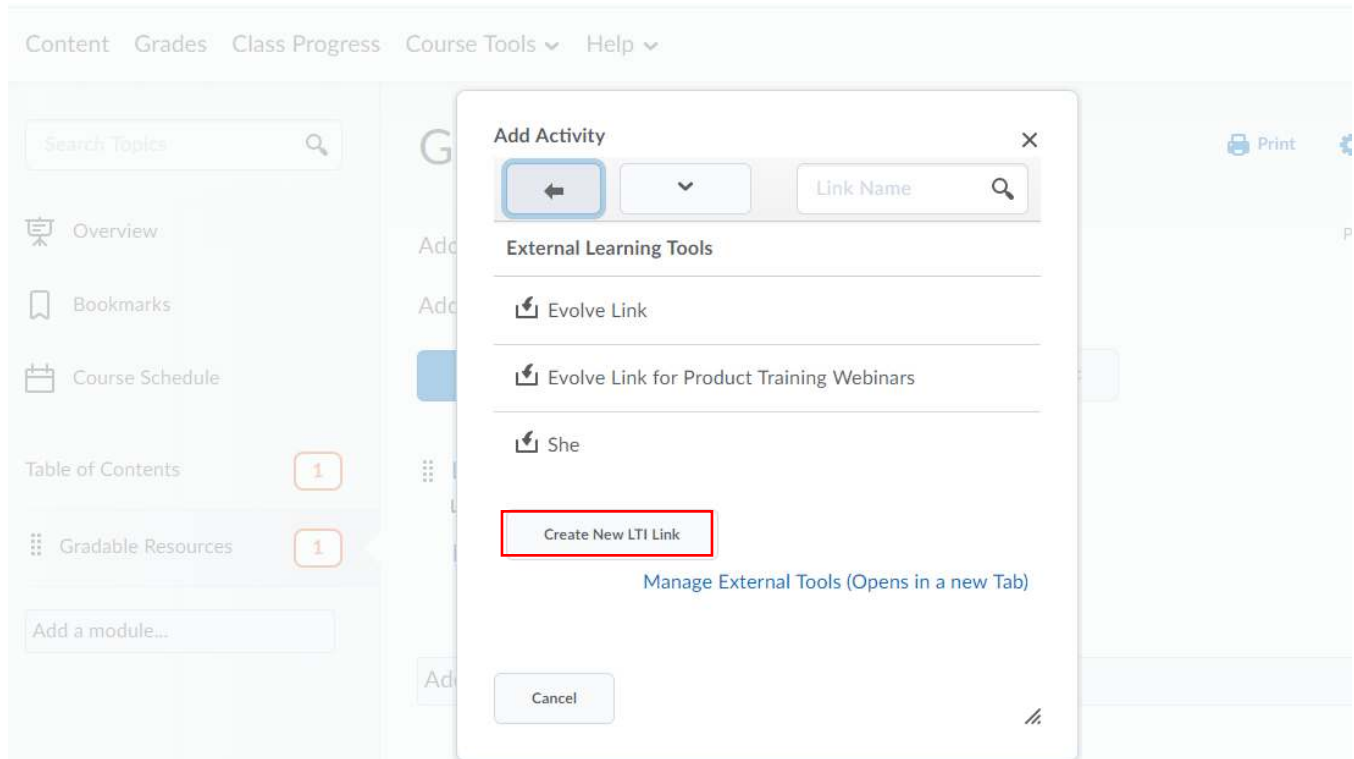

5. Click the button Create New LTI Link

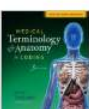

6. In the Evolve Link tab click on the **title** of the resource you are pulling the assignment from.

	Clinical Skills: Skills for Nursing Collection, 1st Edition Clinical Skills Online - Content Library	Create Link
	Elsevier Adaptive Learning for Fundamentals of Nursing, 8th Edition Elsevier Adaptive Learning - Content Library	Create Link
	Evolve Resources for Exploring Medical Language, 10th Edition Resources - Content Library	Create Link
	Medical Terminology Online with Elsevier Adaptive Learning for Medical Terminology & Anatomy for Coding, 3rd Edition Online Course - Content Library	Create Link

Creating Graded Evolve Assignments in Brightspace by D2L

7. Continue clicking through the subfolders until you are at the assignment desired and click the **Create Link** button to the right of the assignment.

Evolve®

My Content > Evolv... > Resou... > Stude... > Grada... > Chapter 01 > Chapter 01 - Exercises

Chapter 01 - Exercises - Build Medical Terms	Create Link
Chapter 01 - Exercises - Define Medical Terms	Create Link
Chapter 01 - Exercises - Analyze Medical Terms	Create Link

ELSEVIER

Copyright © 2019 Elsevier Inc. Terms and Conditions Privacy Policy

RELX Group™

8. A box should appear in the middle of the window, click the **Copy Title** button and go back to the Brightspace by D2L tab.

Evolve®

My Content > Evolv... > Resou... > Stude... > Grada... > Chapter 01 > Chapter 01 - Exercises

Chapter 01 - Exercises - B	Create Link
Chapter 01 - Exercises - D	Create Link
Chapter 01 - Exercises - A	Create Link

Create link

Copy and paste the "Title" and "URL" into your LMS

Copy Title

Copy URL

ELSEVIER Copyright © 2019 Elsevier Inc. Terms and Conditions Privacy Policy RELX Group™



9. In the **Title box**, paste the title you just copied.

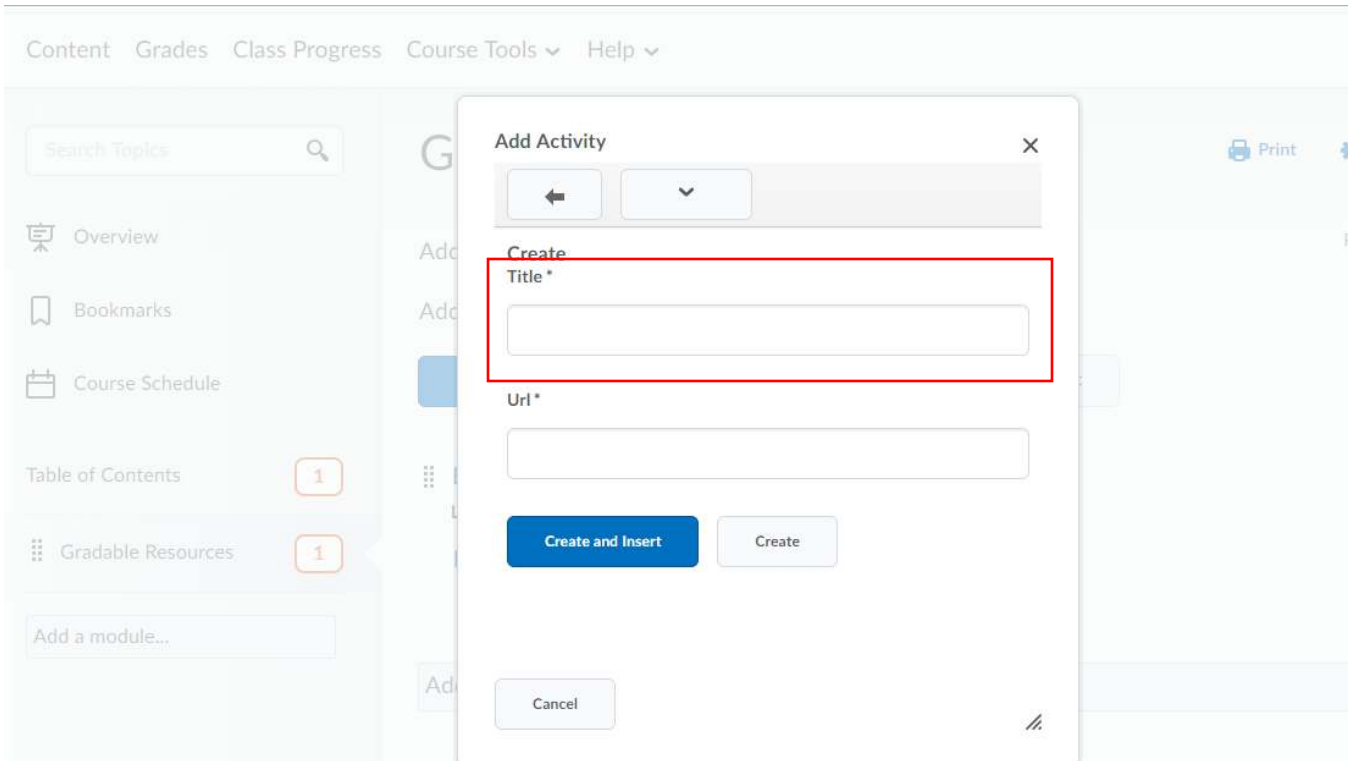

10. Return to the Evolve Link tab and click **Copy URL**.

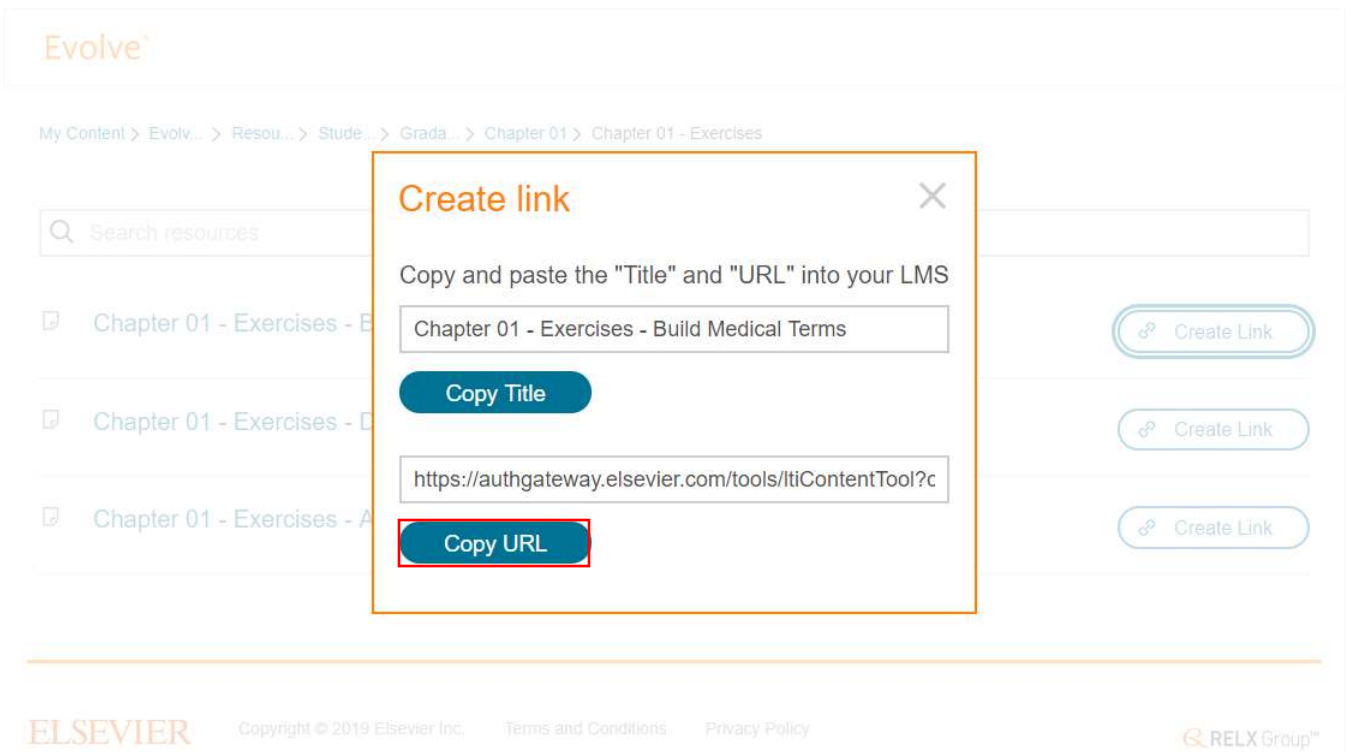

11. In your Brightspace by D2L tab, paste the URL you just copied in **URL box**. Then Click **Create and Insert**.

